

aqigo



Aqigo V3
Product Manual
產品說明書

Thank you for purchasing the
Aqigo V3 Air Purifier

Questions or Concerns?

If you have any questions or concerns, please reach us at www.aqigo.com/contacts/ or whastapp **+852 5415-7221**

Office Hour:

Mon-Fri (10am-6pm UTC+8)

**Thank you and we hope you
enjoy your new purifier!**

Contents

1. Product Specification.....	01
2. Product Structure.....	02
3. Description of Parts and Components.....	03
4. Prepare for Humidification.....	07
5. Filter Replacement Procedures.....	08
6. Maintenance.....	09
7. Correct Placement Position.....	10
8. Important Safety Instructions.....	11
10. Troubleshooting.....	12

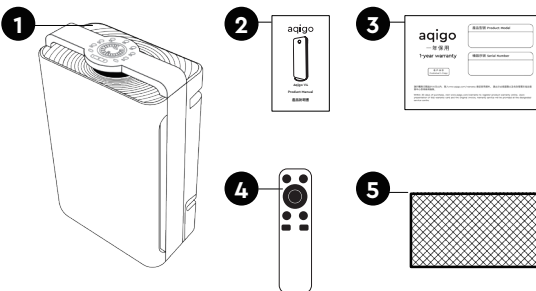

Package contains:

- 1 Aqigo V3 purifier
- 2 User manual card
- 3 Warranty card
- 4 Remote control
- 5 Humidification Mesh

Product Specification

Model Name	Aqigo V3
Applicable Area	600 Square Feet
Color	White
Dimension	400×230×620mm

Net Weight	11.3kg
Voltage	220V-240V
Frequency	50Hz
Rated Power	95W
CADR	488 m ³ /h

Noise Level	24-55dB
Anion Concentration	20million/cm ³
Filters Out H3N2 Virus	>99.9%
Filters Out Bacteria	>99.9%
PM2.5 Removal	>99%

Six Layer Filtration	<ol style="list-style-type: none">1. Antibacterial Filter2. HEPA Filter3. Cold Catalyst Filter4. PACO Filter5. Sterilizing UV light6. Anion Purifier
Recommended HEPA Filter Life Time	6 months
Recommended PACO Filter Life Time	12 months

Features	Filter Replacement Reminders + Child lock + indicate and provide real time feedback for PM2.5 + Timer + Humidify + Sleep mode
Control	Touch panel + Remote control

Product Structure

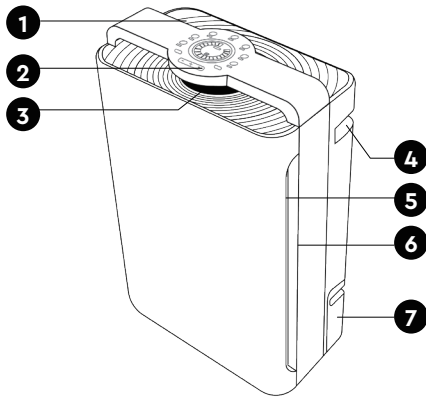

Aqigo V3 Body

- 1 Air Outlet
- 2 Operation Panel & Display Screen
- 3 Indicator Light of Air Quality
- 4 Handle
- 5 Surface Cover
- 6 Air Inlet (On Both Sides)
- 7 Water Tank

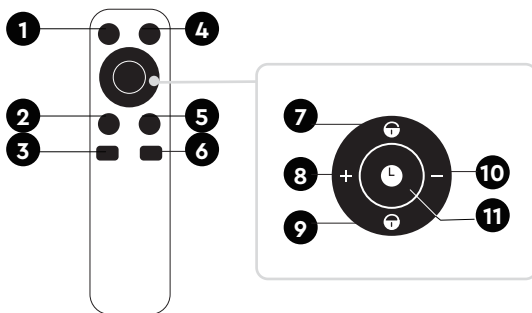

Aqigo V3 Body

- 1 Auto
- 2 Reset
- 3 Sleep
- 4 Power
- 5 Sterilize
- 6 Negative Ion
- 7 Unlock
- 8 Speed +
- 9 Lock
- 10 Speed -
- 11 Timer

Descriptions of Parts and Components

LED display

-  **Green LED**
Air quality is excellent.
-  **Blue LED**
Air quality is good.
-  **Yellow LED**
Air quality is fair.
-  **Red LED**
Air quality is bad.

Control Panel



Powering On/OFF

- 1 Switch Mode**
When the machine is plugged in and stand-by, press "POWER" button to turn on the machine. Press this button again if you wish to switch to standby state. (The icon is red when standby and green when on)

If you press the power button on the operational panel while the machine is running, the machine will enter into standby mode. (And the icon will turn red)

Selecting the Operating Mode

2

Auto

When the machine is on, after "AUTO" button being touched, negative ion generator and germicidal lamp will start working, and the gear will be changed according to sensor's data. (The icon will stay on when the machine operates in auto mode. Otherwise it will be off.)

Attention: if users change wind speed under auto mode, the machine will quit this mode automatically.

3

Timer

When the machine is on, every touch on "TIMER" button will add 1 hour to the timing. When it accumulates to 12 hours, touch it one more to turn it off. (The icon will stay on when the machine operates in timing mode, otherwise it will be off.)

4

Ionizer

When the machine is on, "negative ion" button will turn on negative ion mode and pressing one more time will turn it off. (The icon will stay on when the machine operates in negative ion mode, otherwise it will be off.)

5

Wind Speed

When the machine is on, touch "SPEED -" or "SPEED+" to switch the gear and change the operating speed. After gear being changed, the motor will work only at the setting level without being affected by the sensor. (Touch "wind speed" button, and the machine will quit auto mode)

6

Child Lock

When the machine is on, touch "CHILD LOCK" button to lock all the buttons. At that time all the buttons have no reaction to any touch, while the machine still works how it was set before. Press "CHILD LOCK" button for 5 seconds and the machine will quit this mode. (The icon will stay "on" when the machine operations in child-lock mode, otherwise it will be off)

7 Sleep

When the machine is on, it will enter sleeping mode 5 seconds after the "SLEEP" button is being pressed. In sleeping mode, all the lights will be off and the machine works at the first gear. Press any button to wake it up and then press "SLEEP" button to quit sleeping mode, or press "SPEED" / "SPEED+" / "AUTO" button to quit after waking it up.

8 Reset

This machine has a regular reminding function of filter replacement, which works every 320 hours and 1500 hours. After every 320 hours, the indicator light on the panel will flash to inform users to clean the filter No.1. After cleaning, press the "RESET" button for 5 seconds, then the light will stop flashing. After every 1500 hours, the indicator light will stay on to inform users to renew the filter No.2 and No.3. At that time, press the button for 5 seconds so that the timing can be reset.

The second function of the "RESET" button: when the machine is on. Press this button and the total working time will be shown in hours on the screen. This equals a check of working time. Since the screen can only display three digits at the same time, the thousands digit will be displayed first, then it will display hundreds, tens and single together.

9 Light-sensitive

In auto mode, the machine will turn to sleeping mode 2 minutes after the surrounding light <5lx. It will quit sleeping mode 3 minutes after the surrounding light >5lx, and then continue to work in auto mode.

Remote Control

This product is provided with a remote control powered by button cells. (Please take out the cell if the remote control will not be used for a long periods)

Attention:

- There is one-to-one correspondence between the buttons on the remote control and the operation panel. The functions and operation methods are generally the same.
- On first use, please take out the cell and remove the protective film of the cell, then replace the cell and its cover. otherwise the remote control will not be working without power supply.

Prepare for Humidification

1. Pull the water tank out from the side of the purifier.

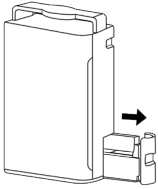

2. Remove the package of the humidifying filter.



3. Put the humidifying filter into the water tank.

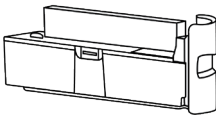

4. Open the rubber lid of the inlet.

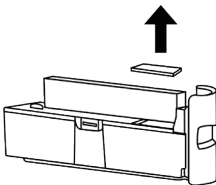

5. Add about 1L cold water through the inlet, filling around 80% of the water tank.

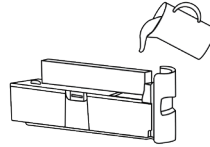

6. After adding water, close the lid

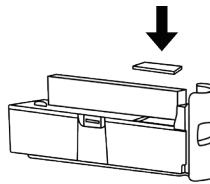

7. Push the tank back into the purifier

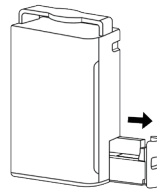

8. This machine has evaporative humidifying function



Water Tank
Light

If water is added into the water tank, the machine will generate steam automatically. The humidification effect is positively related to the wind speed, and it works better when the machine is operating at a higher windspeed.

If the water level is low, the indicator light will flash while the machine continues working normally. If the water tank is taken out, the indicator light will stay on, and the machine will stop working.

Filter Replacement Procedures

1. Removing the filter from the plastic bag:

A. Remove the front cover

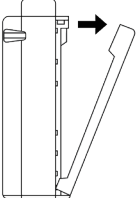

B. Remove the filter

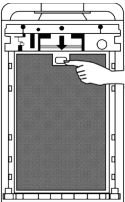

C. Take the filter out of the packaging
(*Make sure to remove plastic bag off the filter before use.)



2. Installing the filter and front cover

A. There are differences between the inside and the outside of the absorption filter 2 (PACO Filter and cold catalyst filter)

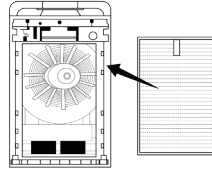

Attention:
The side with a handle should be placed outwards

B. There are differences between the inside and the outside of the dust filter 1 (antibacterial cotton filter and HEPA filter)

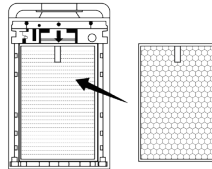

Attention:
The side with a handle should be placed outwards

C. There are differences between the inside and the outside of the front filter (Pre-filter).

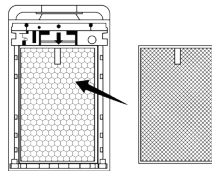

Attention:
The side with a handle should be placed outwards

D. Install the front cover
(* The machine will not operate if the front panel is uncovered)

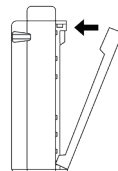

Maintenance

HEPA filter

- Replace the filter every 6 months.
- Hold the frame of filter gently.
- Do not expose under strong sunshine.
- Do not use water to clean the filter.

PACO filter

- Replace the filter every 12 months.
- Hold the frame of filter gently.
- Do not expose under strong sunshine.
- Do not use water to clean the filter.

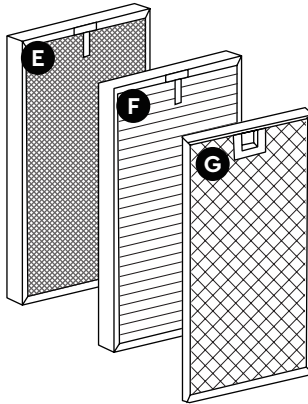

- E** PACO filter
Suggest to replace in every 12 months
- F** HEPA filter
Suggest to replace in every 6 months
- G** Antibacterial filter

Particulate sensor

- Wipe the lens with a dry cotton swab periodically to remove any dirt, (moisture or tobacco residue may cause it to work properly no longer). Fire remove the particulate cover, use a dry cotton swab to wipe the lens.
 - i. Do not insert the cotton swab into any area other than the lens.
 - ii. Be sure to unplug the power cord.
 - iii. If you are unable to see clearly, please use a light.

- **** Friendly Reminders:**
Before cleaning and maintenance, unplug the power cord.
- Do not operate the machine in absence of the filter. It will not be able to remove the dust. Dust taken into the machine may cause malfunction.
- When not using the machine for a long period of time, please unplug it. Power is also consumed while in standby mode.
- You need to replace filters sooner depending on where and how you use the appliance (such as a household with a large smoking population or areas with higher air pollution). Replace the filter if filtration is not noticeable.

Correct Placement Position

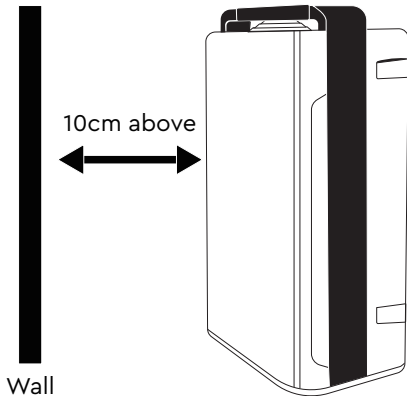

The air inlet of machine should keep a certain distance from the wall and other blockage.

Note:

When using the purifier, it is recommended to close the doors and windows to achieve better purification effect. If you want to move the product, please only lift the product with hidden handlebars on both sides.

Important Safety Instructions

Attention

Precaution in placement

- Use in flat and firm place to avoid dumping, short circuit, leakage, fire and so on.
- Avoid short circuit, fire and other reasons where water is not easily accessible.
- Do not place water containers on the body of the machine to avoid water seepage inside the machine causing insulation damage, leakage, short circuit, fire, etc.
- Do not use in places where oil or flammable gas may leak, so as to avoid fire caused by leakage.
- For indoor use, do not use in places with direct sunshine and access to rainwater.

Warning

Cautions in use

- Before you use, please make sure the plastic package of filter is removed.
- Do not block the air inlet and outlet of this product to avoid overheating inside the machine.
- Do not use outside rated voltage (AC220240V/50Hz). Use outside rated voltage will damage the internal parts of products and cause short circuit, fire and other reasons.
- Do not place next to heater, there is the possibility of fire caused by melting the body.
- Do not disassembly of products for transformation to avoid fire, leakage, injury.
- Pull out the power plug without using it for a long time.
- Do not move the product during the working process of the machine to avoid leakage of electricity.
- Do not touch the power plug with wet hand.
- Don't damage the power cord or socket. Don't cut, refit, excessively twist and drag the power cord. Don't lay heavy objects on the power cord. Otherwise, the power cord may be over heated, and it may cause fire. To repair the power cord or plug, please contact aqigo customer service.
- Don't drag the power cord when moving or storing the appliance.

- When cleaning products or replacing filters, pull out the power plug
- After the machine stops running for 3 minutes, the front panel can be opened to avoid damage caused by the inertia of the wind wheel.
- Do not sit on the body of the machine to avoid injury caused by tilting or turning over.
- If the soft wire of the power supply is damaged, in order to avoid danger, it must be replaced by a manufacturer or maintenance department or similar full-time personnel.

Troubleshooting

1. Cannot turn on power or pressing button has no response.

- Is the Power cord plugged in?
Plug in the power cord.
- Is the purifier covered?
Close the front cover.
- Is the machine placed vertically on the ground?
Place the machine on a flat surface. Is the machine in child-lock mode? When "Child-lock" appears on the display, hold the lock / reset button for 5 seconds to turn off the child-lock.

2. The air is dirty, but the air pollution indicator says "green". The air pollution indicator remains "red" even when continuously running.

- Is the purifier in a place that cannot absorb the dirty air (dust)?
Move it somewhere else.
- Is the particulate sensor dirty?
Clean the particulate sensor.

3. There is a banging or chirping sound while running.

- Is there too much dust on the anion producer?
Clean the anion producer.

4. The smell of the supply vent is unpleasant.

- Is the filter dirty?
Clean the filter.

- ii. Has the filter been replaced in a long time?
Replace the filter.

5. The purifier has been running for a long time but has had no significant improvement in air quality.

- i. Was the plastic bag on the filter removed?
- ii. Is the filter order incorrect?

6. The display shows F1 or F2.

Please turn off the power immediately and contact aqigo customer service.

7. Machine immediately goes to sleep mode.

Deactivate automatic mode